



M.J. Woodworking Machinery Limited
Unit 5&6 Dundrod Road
13 Dundrod Road
Dundrod
Antrim
BT29 4SR

T: (028) 90 825885
M: +447860638816
M: +447894645890

E: info@mjwoodworking.co.uk
W: www.mjwoodworking.co.uk

Suppliers of new and used woodworking machinery, dust extraction, tooling, spare parts and accessories for over 25 years.

M.J.WOODWORKING MACHINERY LTD. OFFER FOR SALE THE FOLLOWING:

1x SCM Ergon Twin Table CNC Router, with fully automatic loading & unloading

All machines now available end of March - early April 2022

Machine Details:

Serial No: [ACL00016/01](#) – [CL00016/02](#)

Year 2008/2009

CNC. Twin Table nesting router machine

Worktable Dimensions - 2120mm x 3120mm

Expanded num control for more than 3 units / 8 axes

Independent X axis for Prisma unit

Machine modification to connect –loading & unloading (Mahros runner)

N. 4 units basic NT 13kw at 30,000rpm instead code 5. Lubricated

N. 4 supplement 250 m3/h vacuum pumps to rich 1000 m3/ total vacuum - 2000 m3/h

Dust extraction system mounted in front of beam work-tables

Centralised exhaust system

1000mcuhr high capacity vacuum

4 x electrospindles - each with 14 position tool changer

2 x rapid 24---24 station supplement tool changers

Mahros fully automatic loading & unloading system for Ergon runner.



Latest offers online at www.mjwoodworking.co.uk

M.J. Woodworking Machinery Limited, Registered in N.Ireland: NI 57986. Vat Reference Number: 422221508. Registered Office: Century House, Enterprise Crescent, Ballinderry Road, Lisburn BT28 2BP



M.J. Woodworking Machinery Limited
Unit 5&6 Dundrod Road
13 Dundrod Road
Dundrod
Antrim
BT29 4SR

T: (028) 90 825885
M: +447860638816
M: +447894645890

E: info@mjwoodworking.co.uk
W: www.mjwoodworking.co.uk

Suppliers of new and used woodworking machinery, dust extraction, tooling, spare parts and accessories for over 25 years.

TERMS OF SALE

PLEASE NOTE ALL MACHINES BOUGHT AS SEEN (NO WARRANTY)

25% DE-POSIT ON CONFIRMATION OF ORDER [NON REFUNDABLE], BALANCE IN FULL PRIOR TO DE-COMMISSIONING OF MACHINE [NO EXCEPTIONS AT ALL]. ALL MONEY MUST BE FULLY CLEARED INTO M.J. WOODWORKING'S BANK ACCOUNT PRIOR TO ANY DE-COMMISSIONING OF MACHINES.

MACHINES WILL BE SAFELY LOADED ONTO CUSTOMERS OWN SELECTED TRANSPORT BY SCM & M.J.WOODWORKING'S ENGINEERS. CUSTOMERS MAY HAVE THEIR OWN ENGINEERS ON SITE FOR THE DE-COMMISSIONING OF THERE PARTICULAR MACHINE. IT WILL BE THE BUYERS FULL RESPONSIBILITY TO ENSURE THEIR OWN EMPLOYEES HAVE ALL NECESSARY SAFETY EQUIPMENT WHILE ON SITE. IN ADDITION, THEY MUST BOOK ALL HOTELS, ECT WELL IN ADVANCE AND PAY FOR THESE PLUS ANY ADDITIONAL EXPENCES.

ALL MACHINES ARE EX-CUSTOMERS SITE NORTHERN IRELAND. ALL BUYERS MUST PROVIDE THEIR OWN TRANSPORT AND TRANSPORT MUST BE ON SITE WHEN DATES AND TIMES ARE ADVISED BY M.J. WOODWORKING MACHINERY LTD. FAILURE TO ADHERE TO THIS CONDITION WILL RESULT IN ADDITIONAL COSTS ALL AT THE BUYERS FULL RESPONSIBILITY.

PLEASE NOTE THERE WILL BE NO TOOLING WITH ANY MACHINES.

CRANES, FORKLIFT, SKATES, JACKS ECT, WILL BE SUPPLIED BY M.J.WOODWORKING MACHINERY LTD, FOR THE SAFE LOADING OF ALL MACHINES ONTO CUSTOMERS OWN TRANSPORT.

Videos of machine in operation can be found by [Clicking Here.](#)



Latest offers online at www.mjwoodworking.co.uk

M.J. Woodworking Machinery Limited, Registered in N.Ireland: NI 57986. Vat Reference Number: 422221508. Registered Office: Century House, Enterprise Crescent, Ballinderry Road, Lisburn BT28 2BP



M.J. Woodworking Machinery Limited
Unit 5&6 Dundrod Road
13 Dundrod Road
Dundrod
Antrim
BT29 4SR

T: (028) 90 825885
M: +447860638816
M: +447894645890

E: info@mjwoodworking.co.uk
W: www.mjwoodworking.co.uk

Suppliers of new and used woodworking machinery, dust extraction, tooling, spare parts and accessories for over 25 years.



Latest offers online at www.mjwoodworking.co.uk

M.J. Woodworking Machinery Limited, Registered in N.Ireland: NI 57986. Vat Reference Number: 42221508. Registered Office: Century House, Enterprise Crescent, Ballinderry Road, Lisburn BT28 2BP



M.J. Woodworking Machinery Limited
Unit 5&6 Dundrod Road
13 Dundrod Road
Dundrod
Antrim
BT29 4SR

T: (028) 90 825885
M: +447860638816
M: +447894645890

E: info@mjwoodworking.co.uk
W: www.mjwoodworking.co.uk

Suppliers of new and used woodworking machinery, dust extraction, tooling, spare parts and accessories for over 25 years.

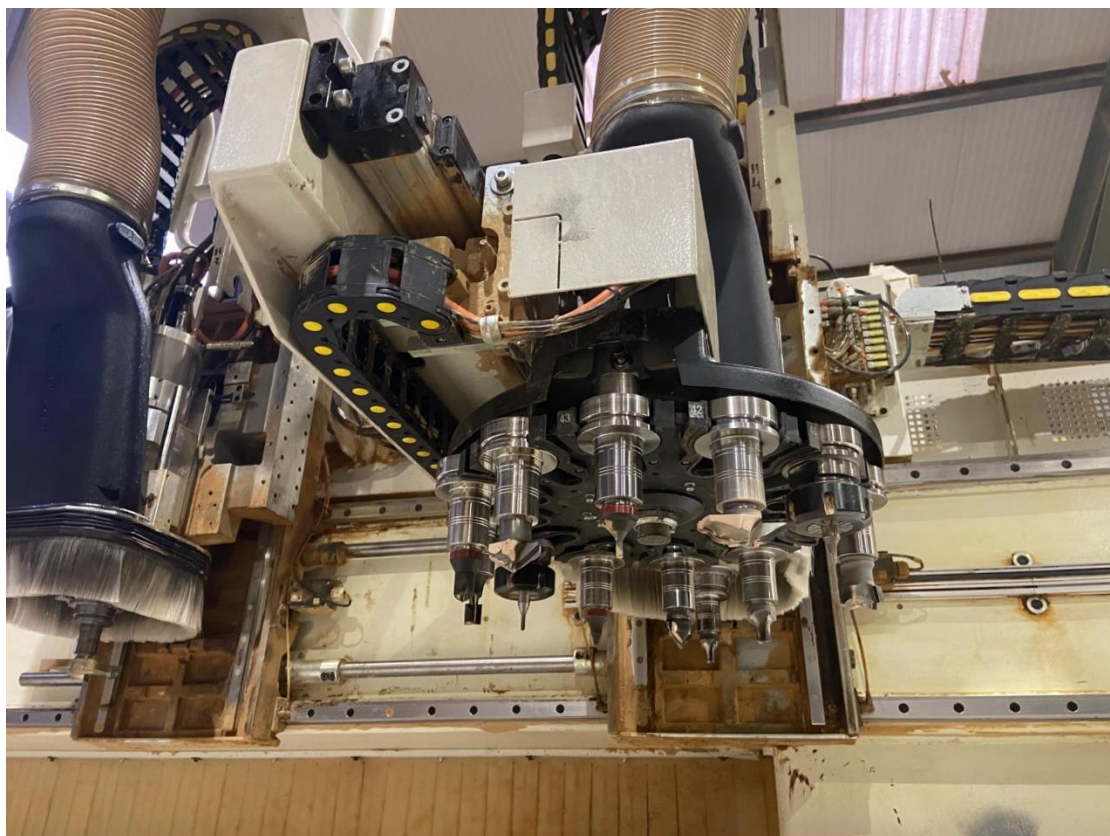

Latest offers online at www.mjwoodworking.co.uk

M.J. Woodworking Machinery Limited, Registered in N.Ireland: NI 57986. Vat Reference Number: 422221508. Registered Office: Century House, Enterprise Crescent, Ballinderry Road, Lisburn BT28 2BP



M.J. Woodworking Machinery Limited
Unit 5&6 Dundrod Road
13 Dundrod Road
Dundrod
Antrim
BT29 4SR

T: (028) 90 825885
M: +447860638816
M: +447894645890

E: info@mjwoodworking.co.uk
W: www.mjwoodworking.co.uk

Suppliers of new and used woodworking machinery, dust extraction, tooling, spare parts and accessories for over 25 years.



Latest offers online at www.mjwoodworking.co.uk

M.J. Woodworking Machinery Limited, Registered in N.Ireland: NI 57986. Vat Reference Number: 422221508. Registered Office: Century House, Enterprise Crescent, Ballinderry Road, Lisburn BT28 2BP

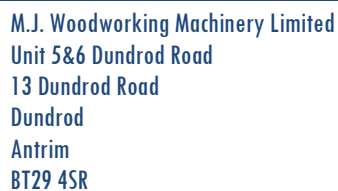

M: +447894645890

W: www.mjwoodworking.co.uk

Suppliers of new and used woodworking machinery, dust extraction, tooling, spare parts and accessories for over 25 years.



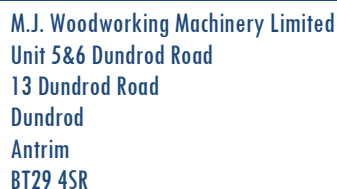

M: +447894645890

W: www.mjwoodworking.co.uk

SCAMBIAITORE DI CALORE (OP7)
HEAT EXCHANGER (OP7)

900 PIANO DI LAVORO
WORKING TABLE

9000

10550

2219

2000

3920

1800

3124

Ø170 PIEDI DI APPOGGIO
SUPPORTING FEET

Ø200

PORTA SCORREVOLE
SLIDING DOOR

300

2000

300

270

300

9400

3574

1330

4095

594

325

600

5655

1405

325

1080

700

800

1800

250

390

1800

1870

1090

618

1717

855

855

1717

618

1090

PIEDI DI APPOGGIO
SUPPORTING FEET

ATTACCO ASPIRAZIONE CENTRALIZZATA
EXHAUST SYSTEM CONNECTION CENTRALIZED

Alloccamento aria compressa (Compressed air connection)

Alloccamento linea elettrica (Electricity connection)

ERMOM L-TOP 270X3120 C.75665

90382902995

M.J. Woodworking Machinery Limited, Registered in N.Ireland: NI 57986. Vat Reference Number: 42221508. Registered Office: Century House, Enterprise Crescent, Ballinderry Road, Lisburn BT28 2BP

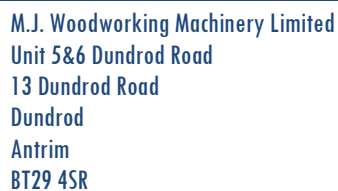

M: +447894645890

W: www.mjwoodworking.co.uk

Suppliers of new and used woodworking machinery, dust extraction, tooling, spare parts and accessories for over 25 years.

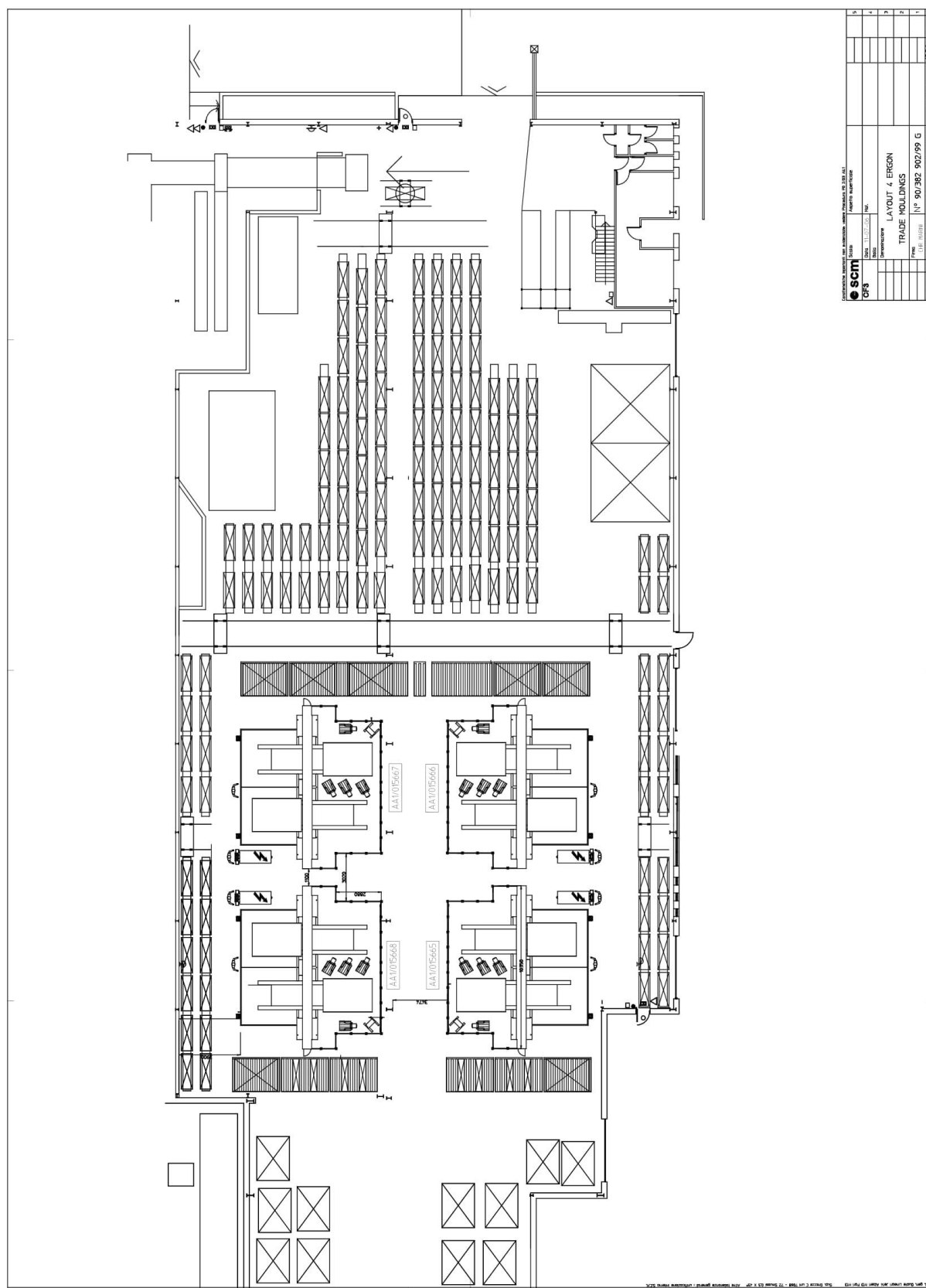

Latest offers online at www.mjwoodworking.co.uk

M.J. Woodworking Machinery Limited, Registered in N.Ireland: NI 57986. Vat Reference Number: 42221508. Registered Office: Century House, Enterprise Crescent, Ballinderry Road, Lisburn BT28 2BP



M.J. Woodworking Machinery Limited
Unit 5&6 Dundrod Road
13 Dundrod Road
Dundrod
Antrim
BT29 4SR

T: (028) 90 825885

M: +447860638816

M: +447894645890

E: info@mjwoodworking.co.uk

W: www.mjwoodworking.co.uk

Suppliers of new and used woodworking machinery, dust extraction, tooling, spare parts and accessories for over 25 years.

TERMS OF TRADING

- 1 ACCEPTANCE OF ORDERS. All contracts of sale made by M.J. Woodworking Machinery ("the Company") shall be deemed to incorporate these Terms and Conditions which shall prevail over any other document or communication from the party with whom the company is dealing ("the Customer"). All orders are accepted and fulfilled subject to these conditions of sale unless varied by agreement in writing.
- 2 PRICE. All prices are ex works and ex VAT. Customers will be invoiced for delivery at current rate. Maintenance of prices is not guaranteed and they are subject to alteration without notice.
- 3 INVOICES. Goods to the customer at the customer's request the company's liability shall cease upon arrival of the vehicle used for such delivery at the customers premises. The safe unloading of the goods shall be the liability of the customer. Unloading begins when the goods are untied or released for movement from the vehicle.
- 4 DELIVERY.
 - (a) Where the company deliver the goods to the customer at the customers request the company's Liability shall cease upon the arrival of the vehicle used for such delivery at the customers premises. The safe unloading of the goods shall be the liability of the customer. Unloading begins when the goods are untied or released for movement from the vehicle.
 - (b) Whilst every effort will be made to despatch the goods on time, no liability can be accepted by the company for failure to deliver the goods in the specified time, all delivery times quoted are business estimates only and form no part of any contractual obligation.
 - (c) The company will accept no liability for shortages, damage or non-delivery of goods unless the Customer notifies the company within seven days of receipt of goods, or receipt of invoice.
 - (d) If for any reason the customer fails, or refuses to accept delivery of the goods at the time such Goods are due and ready for delivery and the customer is found to be in breach of contract the company may sell or otherwise dispose of the goods without prejudice to the company's rights of legal redress for loss suffered in consequence of the customers failure to take delivery of such goods.
 - (e) When the goods are delivered by carrier the company liability for the safety of goods ceases upon The company placing the goods under control of the carrier.
- 5 PAYMENT. All machinery must be paid for in full before despatch. Prices are strictly nett and payment is due within 30 days of invoice date. When the full invoice becomes due. No set off for any reason will be allowed. If payment is not received on the due date the company shall be entitled to interest on any outstanding balances at the rate of 4% above the London Inter Bank lending rate for the time being.
- 6 PROPERTY & TITLE. Ownership of the goods sold shall, notwithstanding delivery, remain with the company until the company has received full payment for such goods. Until such payment has been made, the company may at any time (and without prejudice to any of its other rights) recover or resell the goods or any part of them any may enter on the customers premises for this purpose. The customer may not resell the goods to which the sell retains the title unless he informs the buyer of this condition of sale prior to such resale.
- 7 SPECIFICATIONS. Technical data dimension, weights etc quoted are a guide only and no guarantee is given or implied that the goods will conform in absolute detail to the descriptions and illustrations. The company reserves the right to amend specifications and to withdraw goods from the catalogue without prior notice.
- 8 SUITABILITY. Other than expressly stated in the catalogue or manufacturers brochures, the seller makes no representations as to the fitness or suitability of any goods for any purpose whatsoever.
- 9 LIABILITY. The company shall under no circumstances whatsoever be liable for any indirect or consequential loss however caused. The company's liability for any non performance of any order shall be limited to the value of the goods to which the claim relates.
- 10 CLAIMS. Non delivery of any consignment – must be notified in writing within 7 days of the date of company's invoice. Inspection of the goods immediately on arrival is advised. Damage or short delivery must be notified in writing within 7 days and carriers notes should be endorsed accordingly. NOTE failure to observe the property claims procedure will invalidate the sellers contractual liability under these conditions of sale.
- 11 RETURNS. Undamaged, unopened and fully marketable goods may be returned by prior agreement of the company who reserve the right to make a cancellation/administration charge.
- 12 CANCELLATION OF ORDERS. A 10% cancellation fee will become chargeable on all orders cancelled. Deposits taken from part of a contract sale and are non returnable.
- 13 THIRD PARTY COMPANIES. Any dealings, through any third party are subject to a 1% documentation fee.

Latest offers online at www.mjwoodworking.co.uk

M.J. Woodworking Machinery Limited, Registered in N.Ireland: NI 57986. Vat Reference Number: 422221508. Registered Office: Century House, Enterprise Crescent, Ballinderry Road, Lisburn BT28 2BP